



Chelsea Bridge Wharf, Battersea  
London SW11

GARTONJONES.COM



# Chelsea Bridge Wharf, Battersea London, SW11

## £560 Per Week

A bright and spacious 1 DOUBLE BEDROOM apartment to rent of approx. 500 sq.ft (47 sq.m) in this popular riverside development. This FURNISHED property has an open plan reception room with floor to ceiling patio door windows leading to a private balcony overlooking landscaped fountain gardens. There is a modern kitchen, good storage including built in wardrobes to the bedroom, wood flooring throughout, a 24 hour concierge and an on-site grocery store. Chelsea Bridge Wharf is located between the Power Station and Battersea Park and is within easy reach of the world famous shopping facilities and transport links of Sloane Square.

Please note the furniture may differ or not be included to that shown in current photos.

Council Tax: Wandsworth Council (band D)

5 week deposit required. 12 month minimum term.

EPC Rating: B (81)

- 500 sq.ft
- 1 Double Bedroom
- Bathroom
- Modern Kitchen
- Balcony Overlooking Landscaped Fountain Gardens
- 24 Hour Concierge
- Neighbouring Battersea Park
- On-Site Grocery Store
- Within Easy Reach of The Transport Links of Sloane Square

## GARTON JONES.COM

8 Gatliff Road  
Grosvenor  
Waterside  
Chelsea  
London  
SW1W 8DP

Lettings:  
+44 (0) 20 7730 5007  
gws@gartonjones.com  
www.gartonjones.com



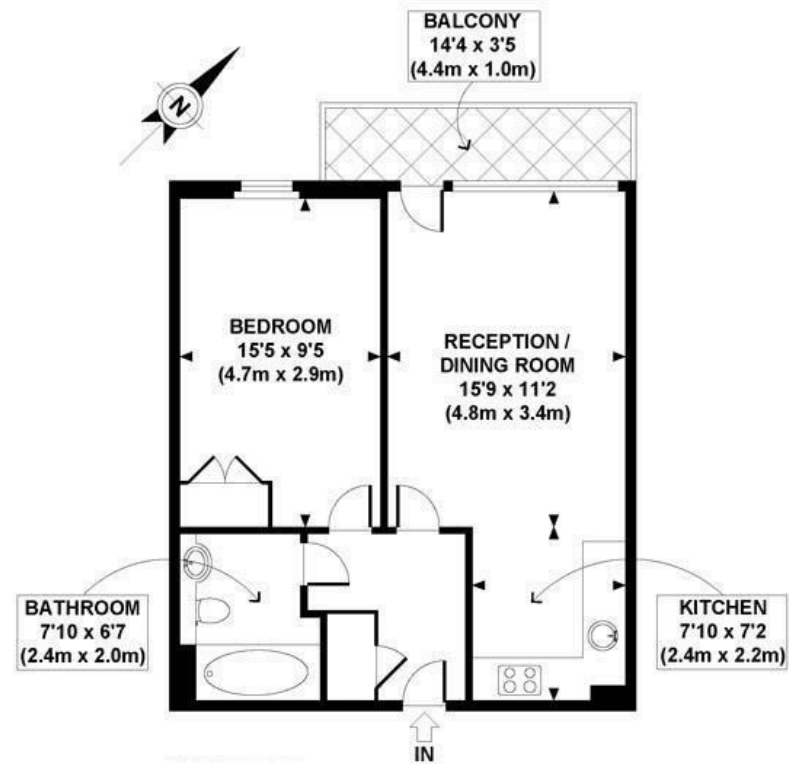

FLOOR AREA 500 SQ FT

APPROX. GROSS INTERNAL FLOOR AREA 500 SQ FT / 47 SQ M  
SRGJW - 010409 Copyright [photoplan.co.uk](http://photoplan.co.uk)

Floorplans are for identification and guideline purposes only, not to scale.  
Compliant with RICS code of measuring practice.



